



MK-2000 SERIES

**TILE SAW
OWNER'S MANUAL &
OPERATING INSTRUCTIONS**



CAUTION:
Read all safety and
operating instructions
before using this
equipment

Enter the Serial Number of your new saw in the space below. The Serial Number is located on the left side of the blade guard.

SERIAL NUMBER:

NOTE:

For your (1) one year warranty to be effective, complete the warranty card (including the Serial Number and mail it in as soon as possible.

EXPLODED VIEW AND PARTS LIST

EXPLODED VIEW:

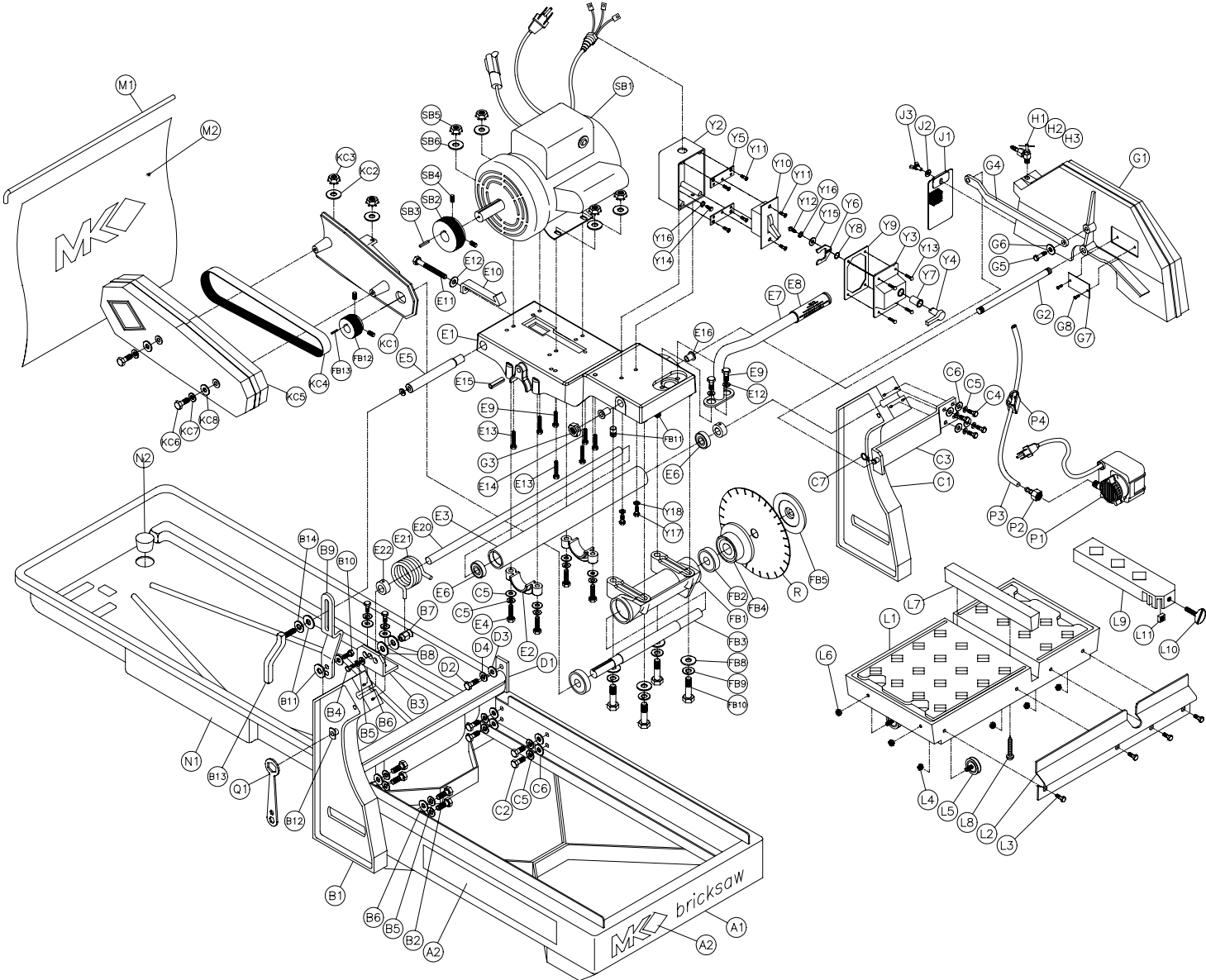

EXPLODED VIEW AND PARTS LIST

PARTS LIST:

Item	Description	Qty	Part #
A	Assembly, Frame, MK2000 Bricksaw	1	n/a
A1	Frame, MK-2000	1	150595
A2	Decal, MK Bricksaw	3	155230
AA	Assembly, Frame PL2000	1	n/a
AA1	Frame, PL-2000	1	
AA2	Decal, Private Label	1	
AB	Assembly, Frame PL2000-HD	1	n/a
AB1	Frame, DP 2001/2002	1	150595-DP
B	Assembly, Upright Left MK2000	1	n/a
B1	Casting, Upright Left (Comp)	1	150592
B2	Screw, 5/16-18 x 3/4, Hex Head	6	151369
B3	Bracket, Spring Adjustment	1	150589
B4	Screw, 5/16-18 x 1 Hex Head	3	151743
B5	Washer, 5/16 Split Lock	9	151747
B6	Washer, 5/16 SAE Flat	9	151754
B7	Stud, Spring Retaining	1	153788
B8	Washer, 1/2 SAE Flat	2	150924
B9	Bar, Cutting Head Adjustment	1	150586
B10	Bolt, 3/8-16 x 1-1/2 Hex Head	1	153528
B11	Washer, 3/8 SAE Flat	2	150923
B12	Nut, 3/8-16 Weld TEE	1	153945
B13	Handle, Lock Nut	1	151140
B14	Washer, 3/8 Split Lock	1	150925
B15	Bolt, 3/8-16 x 1 Hex Head (Shipping not shown)	1	152507
B16	Nut, 3/8 Hex (Shipping not shown)	1	101188
BA	Assembly, Upright Left PL2000	1	n/a
BA1	Casting, Upright Left	1	150592
BA2	Screw, 5/16-18 x 3/4, Hex Head	6	151369
BA3	Bracket, Spring Adjustment	1	150589
BA4	Screw, 5/16-18 x 1 Hex Head	3	151743
BA5	Washer, 5/16 Split Lock	9	151747
BA6	Washer, 5/16 SAE Flat	9	151754
BA7	Stud, Spring Retaining	1	153788
BA8	Washer, 1/2 SAE Flat	2	150924
BA9	Bar, Cutting Head Adjustment	1	150586
BA10	Bolt, 3/8-16 x 1-1/2 Hex Head	1	153528
BA11	Washer, 3/8 SAE Flat	1	150923
BA12	Nut, 3/8-16 Weld TEE	1	153945
BA13	Handle, Lock Nut	1	151140
BA14	Washer, 3/8 Split Lock	1	150925
BA15	Bolt, 3/8-16 x 1 Hex Head (Shipping not shown)	1	152507
BA16	Nut, 3/8 Hex (Shipping not shown)	1	101188

EXPLODED VIEW AND PARTS LIST

BB	Assembly, Upright Left DP-2000	1	n/a
BB1	Casting, Upright Left	1	150592-DP
BB2	Screw, 5/16-18 x 3/4, Hex Head	6	151369
BB3	Bracket, Spring Adjustment	1	150589
BB4	Screw, 5/16-18 x 1 Hex Head	3	151743
BB5	Washer, 5/16 Split Lock	9	151747
BB6	Washer, 5/16 SAE Flat	9	151754
BB7	Stud, Spring Retaining	1	153788
BB8	Washer, 1/2 SAE Flat	2	150924
BB9	Bar, Cutting Head Adjustment	1	150586
BB10	Bolt, 3/8-16 x 1-1/2 Hex Head	1	153528
BB11	Washer, 3/8 SAE Flat	2	150923
BB12	Nut, 3/8-16 Weld TEE	1	153945
BB13	Handle, Lock Nut	1	151140
BB14	Washer, 3/8 Split Lock	1	150925
BB15	Bolt, 3/8-16 x 1 Hex Head (Shipping not shown)	1	152507
BB16	Nut, 3/8 Hex (Shipping not shown)	1	101188
C	Assembly, Upright Right MK2000	1	n/a
C1	Casting, Upright Right	1	150593
C2	Screw, 5/16-18 x 3/4, Hex Head	6	151369
C3	Bracket, Blade Guard	1	150582
C4	Bolt, 5/16-18 x 1 Hex Head	4	151743
C5	Washer, 5/16 Split Lock	10	151747
C6	Washer, 5/16 SAE Flat	10	151754
C7	Clip, Hairpin 1/4 Shaft	1	153953
CA	Assembly, Upright Right PL2000	1	n/a
CA1	Casting, Upright Right	1	150593
CA2	Screw, 5/16-18 x 3/4, Hex Head	6	151369
CA3	Bracket, Blade Guard	1	150582
CA4	Bolt, 5/16-18 x 1 Hex Head	4	151743
CA5	Washer, 5/16 Split Lock	10	151747
CA6	Washer, 5/16 SAE Flat	10	151754
CA7	Clip, Hairpin 1/4 Shaft	1	153953
CB	Assembly, Upright Right DP-2001	1	n/a
CB1	Casting, Upright Right	1	150593-DP
CB2	Screw, 5/16-18 x 3/4, Hex Head	6	151369
CB3	Bracket, Blade Guard	1	150582
CB4	Bolt, 5/16-18 x 1 Hex Head	4	151743
CB5	Washer, 5/16 Split Lock	10	151747
CB6	Washer, 5/16 SAE Flat	10	151754
CB7	Clip, Hairpin 1/4 Shaft	1	153953
D	Assembly, Crossbar Support	1	n/a
D1	Corssbar, Support	1	150594
D2	Bolt, 5/16-18X1 Hex Hd	4	151743

EXPLODED VIEW AND PARTS LIST

D3	Washer, 5/16 SAE Flat	4	151754
D4	Washer, 5/16 Split	4	151747
DA	Assembly, Crossbar Support DP-2001	1	n/a
DA1	Corssbar, Support	1	150594-DP
DA2	Bolt, 5/16-18X1 Hex Hd	4	151743
DA3	Washer, 5/16 SAE Flat	4	151754
DA4	Washer, 5/16 Split	4	151747
E	Assembly, Cutting Head MK2000	1	n/a
E1	Head, Brick Saw, Die Cast, Motor Mounting	1	160346
E2	Clamp, Brick Saw Die Cast Motor Mounting Head	2	160397
E3	Housing, Pivot Shaft	1	157979
E4	Screw, 5/16-18 x 2 1/2, Hex Head Tap	4	151748
E5	Shaft, Threaded	1	150585
E6	Bearing, Pivot Shaft	2	140004
E7	Handle	1	139931
E8	Grip, Handle	1	139949
E9	Screw, 3/8-16 x 3/4, Hex Head Cap	2	152507
E10	Strap, Motor Adjustment	1	150584
E11	Screw, 3/8-16 x 3 1/2 Hex Head Cap	1	153147
E12	Washer, 3/8 SAE Flat	1	150923
E13	Screw, 5/16-18 x 1 3/4, Hex Head Cap	4	160948
E14	Screw, 5/16-18 x 2" Hex Head Tap	1	157938
E15	Pin, Split Wrist	1	151358
E16	Bushing, Plastic	2	156441
E17	Label, Caution, Owners Manual 4 x 1 1/4	1	155576
E18	Label, Caution, Overtension of Belts	1	155583
E19	Washer, 3/8 Split Lock	2	150925
E20	Motor Mount, Pivot Shaft	1	154147
E21	Spring, Torsion Pivot Shaft	1	150587
E22	Collar, Pivot Shaft	2	140012
EA	Assembly, Cutting Head PL2000	1	n/a
EA1	Head, Brick Saw, Die Cast, Motor Mounting	1	160346
EA2	Clamp, Brick Saw Die Cast Motor Mounting Head (comp) Clamp, Brick Saw Die Cast Motor Mounting Head (raw)	2 1	160397 160347
EA3	Housing, Pivot Shaft	1	157979
EA4	Screw, 5/16-18 x 2 1/2, Hex Head Tap	4	151748
EA5	Shaft, Threaded	1	150585
EA6	Bearing, Pivot Shaft	2	140004
EA7	Handle	1	139931
EA8	Grip, Handle	1	139949
EA9	Screw, 3/8-16 x 3/4, Hex Head Cap	2	152507
EA10	Strap, Motor Adjustment	1	150584
EA11	Screw, 3/8-16 x 3 1/2 Hex Head Cap	1	153147
EA12	Washer, 3/8 SAE Flat	1	150923
EA13	Screw, 5/16-18 x 1 3/4, Hex Head Cap	4	160948

EXPLODED VIEW AND PARTS LIST

EA14	Screw, 5/16-18 x 2" Hex Head Tap	1	157938
EA15	Pin, Split Wrist	1	151358
EA16	Bushing, Plastic	2	156441
EA17	Label, Caution, Owners Manual 4 x 1 1/4	1	155576
EA18	Label, Caution, Overtension of Belts	1	155583
EA19	Washer, 3/8 Split Lock	2	150925
EA20	Motor Mount, Pivot Shaft	1	154147
EA21	Spring, Torsion Pivot Shaft	1	150587
EA22	Collar, Pivot Shaft	2	140012
EB	Assembly, Cutting Head DP-2001	1	n/a
EB1	Head, Brick Saw, Die Cast, Motor Mounting	1	160346-OR
EB2	Clamp, Brick Saw Die Cast Motor Mounting Head	2	160397-OR
EB3	Housing, Pivot Shaft	1	157979
EB4	Screw, 5/16-18 x 2 1/2, Hex Head Tap	4	151748
EB5	Shaft, Threaded	1	150585
EB6	Bearing, Pivot Shaft	2	140004
EB7	Handle	1	139931
EB8	Grip, Handle	1	139949
EB9	Screw, 3/8-16 x 3/4, Hex Head Cap	2	152507
EB10	Strap, Motor Adjustment	1	150584
EB11	Screw, 3/8-16 x 3 1/2 Hex Head Cap	1	153147
EB12	Washer, 3/8 SAE Flat	1	150923
EB13	Screw, 5/16-18 x 1 3/4, Hex Head Cap	4	160948
EB14	Screw, 5/16-18 x 2" Hex Head Tap	1	157938
EB15	Pin, Split Wrist	1	151358
EB16	Bushing, Plastic	2	156441
EB17	Label, Caution, Owners Manual 4 x 1 1/4	1	155576
EB18	Label, Caution, Overtension of Belts	1	155583
EB19	Washer, 3/8 Split Lock	2	150925
EB20	Motor Mount, Pivot Shaft	1	154147
EB21	Spring, Torsion Pivot Shaft	1	150587
EB22	Collar, Pivot Shaft	2	140012
F	Assembly, Blade Shaft MK2000	1	154636
F1	Casting, Blade Shaft-Arbor, Complete	1	153791
F2	Bearing, Blade Shaft MK-2000, 5000	2	154594
F3	Shaft, Blade	1	154639
F4	Flange, Inner Steel, 12L14 3-5/8 Diameter	1 .08'	154640 154260
F5	Flange, Outer 14 Inch M-Saw Steel, 12L14 3-5/8 Diameter	1 .16'	132290 154260
F6	Screw, 1/2-20 x 1-1/4, Hex Head	1	152122
F7	Pin, Arbor Alignment	2	153946
F8	Screw, 5/16-18 x 2-1/2	4	101675
F9	Washer, 5/16 Split Lock	4	151747
F10	Washer, 5/16 SAE Flat	4	151754
F11	Pulley, 1 Groove 2-1/2OD x 3/4 ID	1	133140

EXPLODED VIEW AND PARTS LIST

F12	Screw, 5/16-18 x 1/4 Set Cup Point	1	152607
F13	Key, 1-1/8 x 3/16	1	157561
FA	Assembly, Blade Shaft PL2000	1	154636
FA1	Casting, Blade Shaft-Arbor, Complete	1	153791
FA2	Bearing, Blade Shaft MK-2000, 5000	2	154594
FA3	Shaft, Blade	1	154639
FA4	Flange, Inner	1	154640
FA5	Flange, Outer 14 Inch M-Saw	1	132290
FA6	Screw, 1/2-20 x 1-1/4, Hex Head	1	152122
FA7	Pin, Arbor Alignment	2	153946
FA8	Screw, 5/16-18 x 2-1/2	4	101675
FA9	Washer, 5/16 Split Lock	4	151747
FA10	Washer, 5/16 SAE Flat	4	151754
FA11	Pulley, 1 Groove 2-1/2OD x 3/4 ID	1	133140
FA12	Screw, 5/16-18 x 1/4 Set Cup Point	1	152607
FA13	Key, 1-1/8 x 3/16	1	157561
FB	Assembly, Blade Shaft (elec) 1725rpm	1	n/a
FB1	Blade Shaft-Arbor	1	154637
FB2	Bearing, Blade Shaft	2	154594
FB3	Shaft, Arbor	1	154639
FB4	Flange, Inner	1	154640
FB5	Flange, Outer 14 Inch M-Saw	1	132290
FB6	Screw, 1/2-20 x 1-1/4, Hex Head Cap	1	152122
FB8	Washer, 5/16 Split Lock	4	151747
FB9	Washer, 5/16 SAE Flat	4	151754
FB10	Screw, 5/16-18 x 2-1/4,	4	153951
FB11	Pin, Arbor Alignment	2	153946
FB12	Pulley, 10J19 X .75 Bore	1	160950
FB13	Key, 1-1/8 X 3/16	1	150344
G	Assembly, Blade Guard MK2000	1	n/a
G1	Casting, Blade Guard	1	150579
G2	Stud, Blade Guard	1	150581
G3	Nut, 1/2-13 Hex	1	153943
G4	Bar, Adjustment Blade Guard	1	150580
G5	Screw, 3/8-16 x 1 Hex Head Cap	1	152507
G6	Washer, 3/8 SAE Flat	1	150923
G7	Tag, Serial Number, Blank	1	157500
G8	Drive Screw, Round Head, #7 x 5/16	2	157849
GA	Assembly, Blade Guard PL2000	1	n/a
GA1	Casting, Blade Guard	1	150579
GA2	Stud, Blade Guard	1	150581
GA3	Nut, 1/2-13 Hex	1	153943
GA4	Bar, Adjustment Blade Guard	1	150580
GA5	Screw, 3/8-16 x 1 Hex Head Cap	1	152507

EXPLODED VIEW AND PARTS LIST

GA6	Washer, 3/8 SAE Flat	1	150923
GB	Assembly, Blade Guard DP-2000	1	n/a
GB1	Casting, Blade Guard	1	150579-DP
GB2	Stud, Blade Guard	1	150581
GB3	Nut, 1/2-13 Hex	1	153943
GB4	Bar, Adjustment Blade Guard	1	150580
GB5	Screw, 3/8-16 x 1 Hex Head Cap	1	152507
GB6	Washer, 3/8 SAE Flat	1	150923
H	Assembly, Water Control Valve	1	152785
H1	Valve, 1/4 Needle	1	152695
H2	Elbow, 1/4 Street	1	154652
H3	Flare, 1/4 Flare x 1/4 BARB Swivel	1	152694
J	Assembly, Splash Guard	1	n/a
J1	Curtain, Blade Guard MK-2000	1	152417
J2	Bracket, Water Curtain MK-2000	1	152723
J3	Screw, 1/4-20 x 1/2, Hex Head	1	152608
J4	Washer, 1/4 SAE Flat	1	151915
K	Assembly, Belt Guard MK2000	1	n/a
K1	Casting, Belt Guard Outer	1	150591
K2	Casting, Belt Guard Inner	1	150590
K3	Belt, V AX-32, Bricksaw	1	151723
K4	Screw, 5/16-18 x 1-3/4 Hex Hd Cap	2	150919
K5	Kep Nut, 5/16-18, Hex Head	2	153942
K6	Washer, 5/16 SAE Flat	4	151754
KA	Assembly, Belt Guard PL2000	1	n/a
KA1	Casting, Belt Guard Outer	1	150591
KA2	Casting, Belt Guard Inner	1	150590
KA3	Belt, V AX-32, Bricksaw	1	151723
KA4	Screw, 5/16-18 x 1-3/4 Hex Hd Cap	2	150919
KA5	Kepnut, 5/16-18, Hex Head	2	153942
KA6	Washer, 5/16 SAE Flat	4	151754
KB	Assembly, Belt Guard DP-2001	1	n/a
KB1	Casting, Belt Guard Outer	1	150591-DP
KB2	Casting, Belt Guard Inner	1	150590-DP
KB3	Belt, V AX-32, Bricksaw	1	151723
KB4	Screw, 5/16-18 x 1-3/4 Hex Hd Cap	2	150919
KB5	Kep Nut, 5/16-18, Hex Head	2	153942
KB6	Washer, 5/16 SAE Flat	4	151754
KC	Assembly, Belt Guard (1725rpm)	1	n/a
KC1	Belt Guard Inner	1	150590

EXPLODED VIEW AND PARTS LIST

KC2	Washer, 3/8 SAE Flat	2	150923
KC3	Nut, 5/16-18 Hex (w/ external tooth washer)	2	153942
KC4	Belt, Poly-V 10340J	1	160952
KC5	Belt Guard Outer	1	158867
KC6	Screw, 5/16-18 x 1 3/4, Hex Head Cap	2	150919
KC7	Washer, 5/16 Lock Split	2	151747
KC8	Washer, 5/16 SAE Flat	2	151754
KC9	Caution, Guard Removal 3 x 1 1/2	1	155587
KD	Assembly, Belt Guard (1725rpm)	1	n/a
KD1	Belt Guard Inner	1	150590-DP
KD2	Washer, 3/8 SAE Flat	2	150923
KD3	Nut, 5/16-18 Hex (w/ external tooth washer)	2	153942
KD4	Belt, Poly-V 10340J	1	160952
KD5	Belt Guard Outer	1	158867
KD6	Screw, 5/16-18 x 1 3/4, Hex Head Cap	2	150919
KD7	Washer, 5/16 Lock Split	2	151747
KD8	Washer, 5/16 SAE Flat	2	151754
KD9	Caution, Guard Removal 3 x 1 1/2	1	155587
L	Assembly, Table MK2000	1	133082
L1	Casting, Table MK-2000	1	158144
L2	Stop-Rule, Table MK-2000	1	134387
L3	Screw, 1/4-20 x 3/4 Hex Head	4	152370
L4	Nut, 1/4-20, Hex with Washer	4	153941
L5	Wheel, Roller MK-2000 Bricksaw	4	133090
L6	Nut, 5/16-18 hex	4	153942
L7	Wood Strip, Table Insert	1	158283
L8	Screw, Pan HD Phil. #8 x 1	2	151047
L9	Casting, Squaring Arm MK2000	1	231276
L10	Screw, 15/16-18 x 1-1/2, Thumb	1	151155
L11	Nut, 5/16-18, Square	1	151156
LA	Assembly, Table DP-2001	1	133082-DP
LA1	Casting, Table DP-2001	1	158144-DP
LA2	Stop-Rule, Table MK-2000	1	134387
LA3	Screw, 1/4-20 x 3/4 Hex Head	4	152370
LA4	Nut, 1/4-20, Hex with Washer	4	153941
LA5	Wheel, Roller MK-2000 Bricksaw	4	133090
LA6	Nut, 5/16-18 hex	4	153942
LA7	Wood Strip, Table Insert	1	158283
LA8	Screw, Pan HD Phil. #8 x 1	2	151047
LA9	Casting, Squaring Arm MK2000	1	231276
LA10	Screw, 15/16-18 x 1-1/2, Thumb	1	151155
LA11	Nut, 5/16-18, Square	1	151156
M	Assembly, Curtain MK Logo	1	n/a
M1	Rod, Splash Curtain	1	153956

EXPLODED VIEW AND PARTS LIST

M2	Curtain, Rear MK-2000	1	160972
MA	Assembly, Curtain Plain	1	n/a
MA1	Rod, Splash Curtain	1	153956
MA2	Curtain, Rear Plain	1	160972
MB	Assembly, Curtain, Home Depot	1	n/a
MB1	Rod, Splash Curtain	1	153956
MB2	Curtain, Rear MK2000 no logo	1	152569
N	Assembly, Pan	1	
N1	Pan, Plastic MK-2000	1	150308
N2	Plug, Rubber Drain Without Hole	1	153439
P	Assembly, Pump Electric	1	n/a
P1	Pump, Water G-150A	1	151271
P2	Fitting, Plastic 1/4 FNPT X 1/4 BARB	1	128397
P3	Hose, Vinyl 1/4 ID	3'	132951
P4	Clamp, Flow 1/4-1/2	1	154394
P5	Owner's Manual, Water Pump G-150A	1	155745
P6	Carton, Water Pump G-150A	1	154016
P7	Insert, Foam Water Pump G-150A	1	154017
Q	Assembly, Accessory Pack	1	n/a
Q1	Wrench, Masonry Saw	1	134056
Q2	Label, MK Bricksaw 12-1/2 x 1-3/4	1	155230
Q3	Carton, Accessory MK-2000	1	153575
Q4	Insert, Accessory MK-2000	1	153576
Q4	Sell Sheet, Tile Accessory	1	156915
Q5	Blade, MK-BX30	1	157944
Q6	Owners Manual, MK-2001 and MK-2002	1	156402
Q7	Card, Warranty Rental	1	155666
Q8	Cord, GFCI 20A W/ Twist Lock	1	155430
Q9	Cord, Extension L5-15 X 25'	1	158111
R	Assembly, Carton	1	n/a
R1	Carton, Bricksaw	1	151941
R2	Pallet, MK-2000	1	153758
R3	Carton, Insert Bricksaw	2	151943
S	Assembly, Mtr 115/230v 60 Hz 1 Ph 1.5 Hp		n/a
S1	Motor, 115/230v 60 Hz 1.5 Hp	1	231082
	a Receptacle, 20 Amp 115 volt	1	154621
	b Switch, Voltage Change	1	150577
	c Switch, Thermal Overload (TPMISJ24AB)	1	153503
	d Box, Switch Bricksaw	1	139758
	e Switch, On/Off 30 Amps/250 volts	1	139741
	f Cover, Switch Box Bricksaw	1	139766

EXPLODED VIEW AND PARTS LIST

	g Screw, 10-32 x 1/4, Slotted Round Head Machine	4	231090
	h Plug, Twist Lock 20 Amp 125 volt (NEMAL520P)	1	154556
	i Cord Connectors, 1/2 Appleton (CG5050)	1	151307
	j Capacitor, HSG	1	150574
	k Capacitor, Oil MK2000 (OC3020F12)	1	152412
S2	Pulley, 1 Groove, 2-1/4 x 5/8, AK22	1	133157
S3	Key, 1-1/8 x 3/16	1	157561
S4	Screw, 5/16-18 x 1/4 Set Cup Point	1	152607
S5	Kep Nut, 5/16-18, Hex Head	4	153942
S6	Washer, 5/16 SAE Flat	4	151754
S7	Screw, 1/4-20 x 1 Hex Head	2	152676
S8	Nut, Hex, 10-24	1	151749
S9	Screw, Fil HD Slot, 10-24X1	1	151751
SA	Assembly, Mtr 110/220v 1 Ph 50 Hz 1.5 Hp		n/a
SA1	Motor, 115/230v 50 Hz 1.5 Hp	1	151184
	a) Receptacle, 20 Amp 115 volt	1	154621
	b) Switch, Voltage Change	1	150577
	c) Switch, Thermal Overload (TPMISJ24AB)	1	153503
	d) Box, Switch Bricksaw	1	139758
	e) Switch, On/Off 30 Amps/250 volts	1	139741
	f) Cover, Switch Box Bricksaw	1	139766
	g) Screw, 10-32 x 1/4, Slotted Round Head Machine	4	231090
	h) Plug, Twist Lock 20 Amp 125 volt (NEMAL520P)	1	154556
	i) Cord Connectors, 1/2 Appleton (CG5050)	1	151307
	j) Capacitor, HSG	1	150574
	k) Capacitor, Oil MK2000 (OC3020F12)	1	152412
SA2	Pulley, 1 Groove, 2-1/4 x 5/8, AK22	1	133157
SA3	Key, 1-1/8 x 3/16	1	157561
SA4	Screw, 5/16-18 x 1/4 Set Cup Point	1	152607
SA5	Kep Nut, 5/16-18, Hex Head	4	153942
SA6	Washer, 5/16 SAE Flat	4	151754
SA7	Screw, 1/4-20 x 1 Hex Head	2	152676
SB	Assembly, Mtr 115v 60 Hz 1 Ph 1.5 Hp (1725rpm)		n/a
SB1	Motor, 115v 60 Hz 1.5 Hp (1725 rpm)	1	161099
SB2	Pulley, 10J28 X 5/8 Bore Screw, 5/16-18 x 3/8 Set	1 2	160949 152676
SB3	Key, 1-1/8 X 3/16	1	150344
SB4	Screw, 5/16-18 x 1/4 Set Cup Point	1	152607
SB5	Kep Nut, 5/16-18, Hex Head	4	153942
SB6	Washer, 5/16 SAE Flat	4	151754
SB7	Screw, 1/4-20 x 1 Hex Head	2	152676
SB8	Label, Warning, Cord Selection 2 3/4 x 2 1/2	1	155672
SB9	Label, Caution, GFCI, 1 X 2 1/8	1	155678
SB10	Label, Caution, .6 Amp Max. 1 X 2-1/8	1	154822
SB11	Label, Motor, Cool Push 1 x 5/8	1	154409

EXPLODED VIEW AND PARTS LIST

Y1	Assembly, 30amp Switch Box	-	161101
Y2	Box, Top Entry, 30A Switch (Comp)	1	159487
	Box, 30A Switch (Raw)	1	158794
Y3	Cover, 30A Switch Box (Comp)	1	159539
	Cover, 30A Switch Box (Raw)	1	158795
Y4	Lever, Actuator, 30A Switch Box (Comp)	1	159540
	Lever, Actuator, 30A Switch Box (Raw)	1	158796
Y5	Plate, Mounting, 30A Switch	2	159489
Y6	Lever, On/Off, 30A Switch Box	1	159490
Y7	Bushing, Nylon, 30A Switch Box	1	158799
Y8	Seal, Urethane, 30A Switch Box	1	159492
Y9	Gasket, 30A Switch Box	1	159491
Y10	Switch, 30A/2HP/120V/DPST	1	159488
Y11	Screw, 6-32 X 5/16 Flat Head Phillips Machine	6	159493
Y12	Screw, 10-24 X 5/16 Pan Head Phillips Machine	1	159494
Y13	Screw, 6-32 X 5/8 Pan Head Phillips Machine	4	157393
Y14	Screw, 10-24 X 5/16 Slotted Hex Washer Head Grounding	1	159597
Y15	Washer, #10 SAE Flat	1	154369
Y16	Washer, #10 Lock, Internal Teeth	1	158336
Y17	Screw, 1/4-20 x 3/4 Hex Head Cap	2	152370
Y18	Washer, 1/4 Split Lock	2	152591
Y19	Connector, Liquid Tight Cord	1	159582