



# MK-770 SERIES

**TILE SAW  
OWNER'S MANUAL &  
OPERATING INSTRUCTIONS**



**CAUTION:**  
Read all safety and  
operating instructions  
before using this  
equipment

Enter the Serial Number of your new saw in the  
space below. The Serial Number is located on the  
rear of the Cutting Head.

**SERIAL NUMBER:**

**NOTE:**

For your (1) one year warranty to be effective,  
complete the warranty card (including the Serial  
Number and mail it in as soon as possible.

# EXPLODED VIEW AND PARTS LIST

## EXPLODED VIEW:

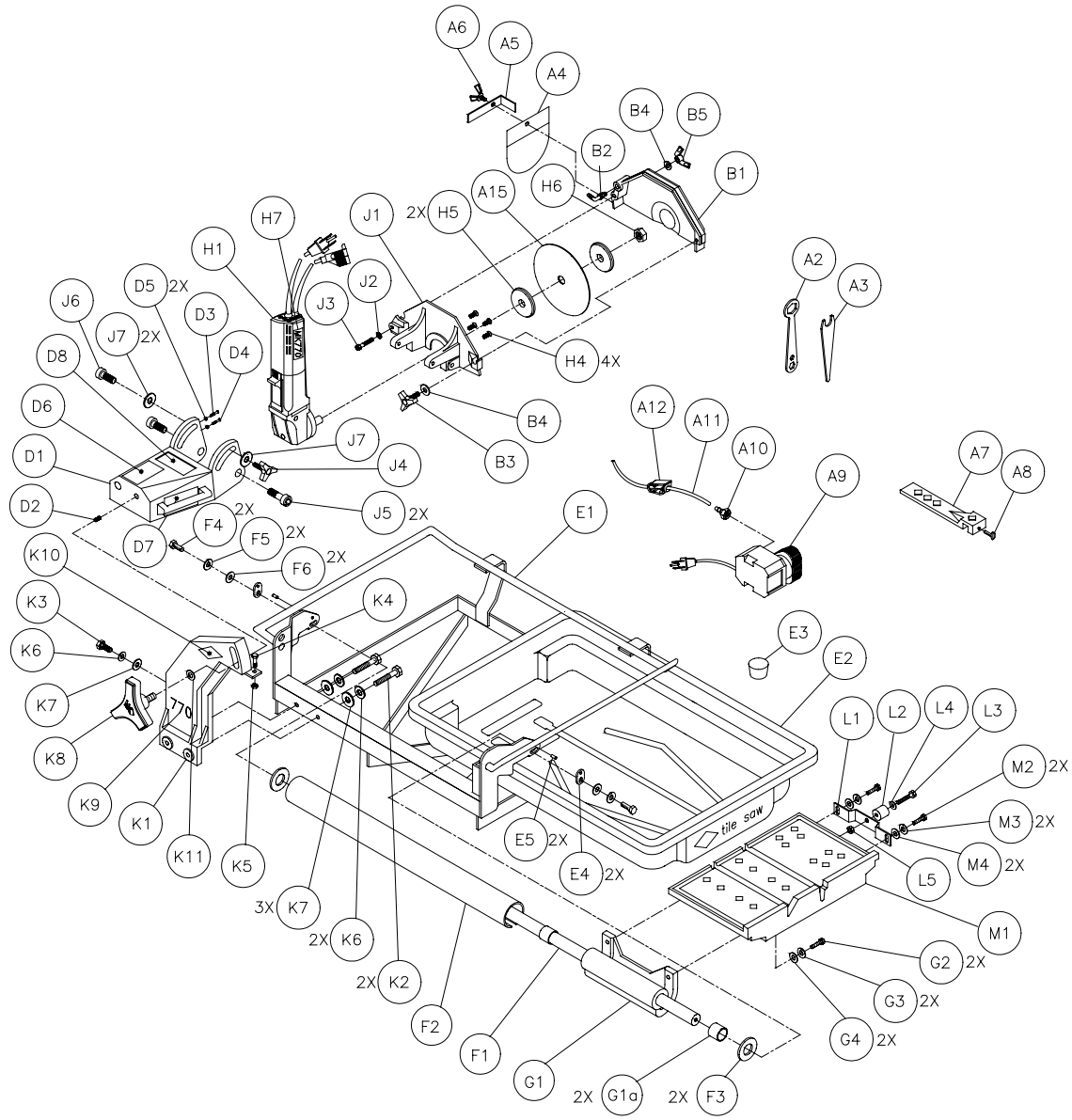

## EXPLODED VIEW AND PARTS LIST

### PARTS LIST:

Item	Description	Qty	Part #
<b>A Accessories</b>			n/a
A1	Carton, Accessory pack, 770	1	153498
A2	Wrench, Blade Nut, 15/16 Boxed End	1	134684
A3	Wrench, Blade Shaft, 11/16 Open End	1	153450
A4	Curtain, Splash	1	134841
A5	Bracket, Splash Curtain	1	155901
A6	Wing-screw, 1/4-20 x 1/2	1	151888
A7	Casting, Rip Guide (comp)	1	134551
A8	Screw, 1/4-20 X 3/4 Thumb	1	150991
A9	Pump, 120v Water	1	151271
A10	Fitting, Plastic, 1/4 FNPT x 1/4 BARB	1	128397
A11	Hose, Vinyl, 1/4 ID	2 1/2'	132951
A12	Clamp, Flow, 1/4-1/2	1	154394
A13	Owner's Manual, Water Pump, G-150A	1	155745
A14	Plug, Nema 5-15P 15a/120v	1	150869
A15	Blade, 7 x 060 x 5/8, MK-100 (saws)	1	153441
A16	Owner's Manual, 770	1	153618
A17	Warranty Card	1	155037
<b>B Blade Guard</b>			154811-MK
B1	Casting, Guard, 7" Blade, (comp)	1	154811
B2	Elbow, 1/8 MNPT x 1/4" Barb 90° Brass	1	154652
B3	Knob, Davies	1	151681
B4	Washer, 5/16 SAE Flat	2	151754
B5	Wing-nut, 5/16-18 Nylock	1	151746
<b>D Cutting Head</b>			n/a
D1	Casting, Cutting Head (comp)	1	151733
D2	Helicoil, 3/8-16	1	151880
D3	Screw, Slotted Pan Hd 10-32 x 1/4"	1	151750
D4	Screw, Slotted Pan Hd 10-32 x 1"	1	151751
D5	Nut, Hex 10-32	2	151749
D6	Label, Warning, Safety	1	155806
D7	Label, MK-USA	1	154334
D8	Tag, Serial Number MK-770	1	156546
<b>E Frame</b>			n/a
E1	Frame	1	153322
E2	Pan, Plastic	1	151736
E3	Plug, Water Drain	1	153439
E4	Plate, Adjustment	2	151758
E5	Pin, Rolled	2	151783
<b>F Guide Bar, 5/8 Dia.</b>			151739-MK
F1	Bar, Guide, 5/8 Dia.	1	151739
F2	Cover, 5/8 Guide Bar	1	151740
F3	Spacer, 5/8 Guide Bar Cover	2	151755
F4	Screw, 5/16-18 x 1 Hex Head Cap	2	151743
F5	Washer, 5/16 Split Lock	2	151747
F6	Washer, 5/16 SAE Flat	2	151754

## EXPLODED VIEW AND PARTS LIST

Item	Description	Qty	Part #
<b>G</b>	<b>Linear Bearing</b>		151737-MK
G1	Casting, Bearing, Linear (comp)	1	151737
G1a	Bearing, Multi-Lube	2	151781
G2	Screw, 5/16-18 x 1 Hex Head Cap	2	151743
G3	Washer, 5/16 Split Lock	2	151747
G4	Washer, 5/16 SAE Flat	2	151754
<b>H</b>	<b>120v Motor</b>	1	n/a
H1	Motor, 120v/7.4A	1	156428-R
H1A	Motor, 240v/2.7A, 770	1	157054
H2	Label, Caution, GFCL, 1 X 2 1/8	1	155678
H3	Label, Caution, Receptacle, 1 X 2 1/8	1	154822
H4	Screw, 10-32 X 5/8 Flat Head Phillips Cap,	4	157554
H5	Flange, Blade	2	135830
H6	Nut, 5/8-18 UNF	1	135848
H7	Label, Motor MK-770	1	156691
H8	Plug, CEE 7/7 16a 240v	1	153687
H9	Plug, 340v/10A Australia	1	156267
<b>J</b>	<b>Motor Mount</b>		n/a
J1	Casting, Motor Mount, (comp)	1	153904
J2	Washer, 5/16 Split Lock	1	151747
J3	Screw, 5/16-18 x 2 1/2 Hex Head Cap, Full Thread	1	151748
J4	Knob, Davies	1	151681
J5	Bolt, Shoulder, Soc. Hd 1/2 x 1/2"	2	151753
J6	Bolt, Shoulder, Soc. Hd 5/16-18 x 5/8	1	152137
J7	Washer, Flat SAE 5/16"	2	151754
<b>K</b>	<b>Post</b>		n/a
K1	Casting, Post (comp)	1	153516
K2	Screw, 3/8-16 x 2", Hex Head	2	153485
K3	Screw, 3/8-16 x 1", Hex Head	1	152507
K4	Screw, 1/4-20 x 1", Hex Head	1	152676
K5	Nut, 1/4-20, Hex	1	151893
K6	Washer, Lock, 3/8	3	150925
K7	Washer, Flat SAE 3/8	3	150923
K8	Knob, Tri-Plastic	1	156770-04
K9	Label, 770	1	155395
K10	Label, MK-Diamond Logo	1	151969
<b>L</b>	<b>Roller Wheel</b>		151756
L1	Bracket, Roller Wheel	1	154021
L2	Wheel, Roller	1	151799
L3	Screw, 1/4-20 x 1 1/2 Hex Head Cap	1	151914
L4	Washer, 1/4 SAE Flat	1	151915
L5	Nut, 1/4-20 Hex	1	151893
<b>M</b>	<b>Table, 770</b>		n/a
M1	Casting, Table, comp	1	151738
M2	Screw, 5/16-18 x 1 Hex Head Cap	2	151743
M3	Washer, 5/16 Split Lock	2	151747
M4	Washer, 5/16 SAE Flat	2	151754